

## Pedals

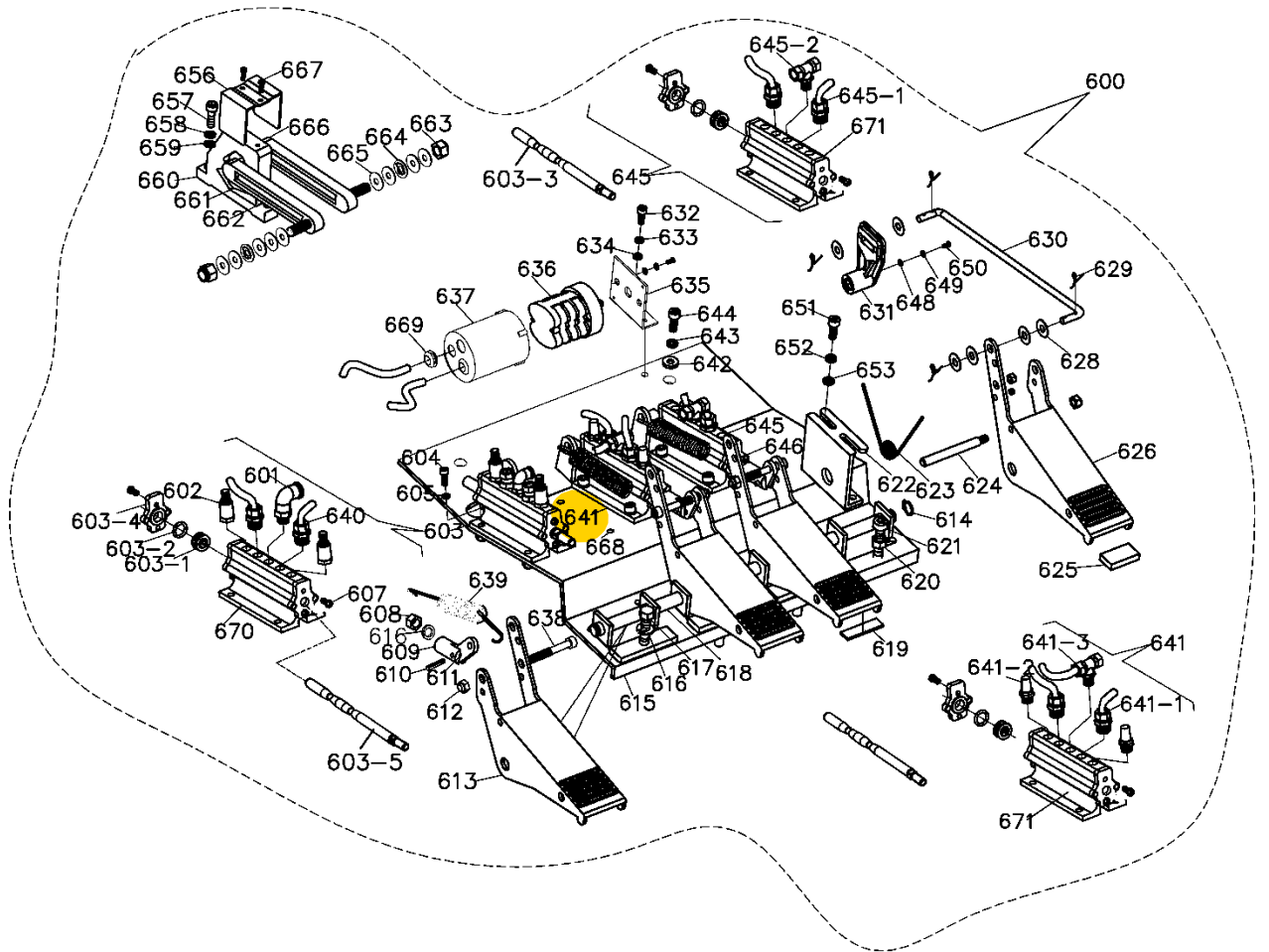

BendPak Part #	Drawing #	Description
5327103	600	Front foot pedal assembly
5400933	601	Fitting, G1/8" Ø8, 90°
5327545	602	1/8" Adjustable silencer
5327387	603	Tilt back air Valve
5327482	603-1	Air Valve O-ring spacer
5327536	603-2	O-ring, 17 x 4
	603-3	Large cylinder Valve stem
5327499	603-4	Air Valve end cap
5327531	603-5	Valve stem
	604	SHCS, M6 x 12
	605	Washer, M6, flat
	607	Cross recessed pan head screw, M4 x 10
	608	Nut, M8
5327374	609	Foot pedal link
5327554	610	Spring pin, M4 x 18

5327408	611	Air Valve connecting link
	612	Locking nut M6
	613	Foot pedal (right)
	614	Snap ring, Ø12
	615	Base board
	616	Washer, Ø8 Split lock
	617	HHB, M8 x 16
	618	Foot pedal shaft
	619	Control system adjusting pad
	620	Nut, M8
	621	SHCS, M8 x 50
	622	Torsion spring bracket
5327035	623	Foot pedal torsion spring
	624	Foot pedal limit rod
	625	Foot pedal rubber insert
5327033	626	Foot pedal (left)
	628	Spacer, Ø6
	629	Pin, Ø3.2 x 25
5327038	630	Directional switch cam linkage
5400324	631	Turntable direction switch cam
	632	SHCS, M6 x 12
	633	Washer, Ø6 split lock
	634	Washer, Ø6 flat
	635	Directional switch bracket
5400331	636	Directional switch, 220V/40A
	637	Directional switch cover
	638	SHCS, M6 x 55
5327034	639	Foot pedal return split lock
5327745	640	Fitting, G1/8" Ø8, straight
5327385	641	Jaw clamp air Valve
	641-1	Fitting, G1/4" Ø8, straight
	641-2	Silencer, G1/4"
	641-3	Fitting, Tee G1/4" Ø8
	642	Spacer, Ø8
	643	Washer, Ø8 split lock
	644	SHCS, M8 x 20
5327386	645	Bead breaker air Valve
	645-1	Fitting, G1/4" Ø10
	645-2	Fitting, Tee G1/4" Ø8
	646	Cylinder retaining bush
	648	Washer, Ø5 flat
	649	Washer, Ø5 split lock

	650	Cross recessed pan head screw, M5 x 16
	651	SHCS, M6 x 16
	652	Washer, M6 flat
5400913	653	Washer, M6 flat
5327412	656	Foot pedal cam cover
	657	SHCS, M6 x 20
	658	Washer, M6 flat
5400913	659	Washer, M6 flat
5327047	660	Foot pedal cam
5327048	661	Foot pedal cam leaf spring (left)
	662	Foot pedal cam leaf spring (right)
	663	Locking nut, M8
	664	Curved spring Washers, Ø8
	665	Washer, Ø8 flat
5327049	666	Foot pedal cam link
	667	Cross recessed pan head screw, M3 x 10
	669	Cable holder
	670	Air Valve (B)
	671	Air Valve (A)