

REVISION				
REV	DESCRIPTION	DATE	EDITED BY	ECO#
L	UPDATED BOM REVISION	11/14/2018	TS	01025
M	REAPLCED 5505350 WITH 5505400, ADDED 5715035 AND 5530366, ADDED LOCK HEIGHTS (pg2), UPDATED BOM REVISIONS	09/20/2019	CA	01128
N	REPLACED 5715035 WITH 5715048, 5530366 WITH 5530364, ADDED 5535357, MOVED DIMENSION PAGE TO TOP LEVEL DRAWING, UPDATED BOM REVISION	07/29/2022	TM	01433

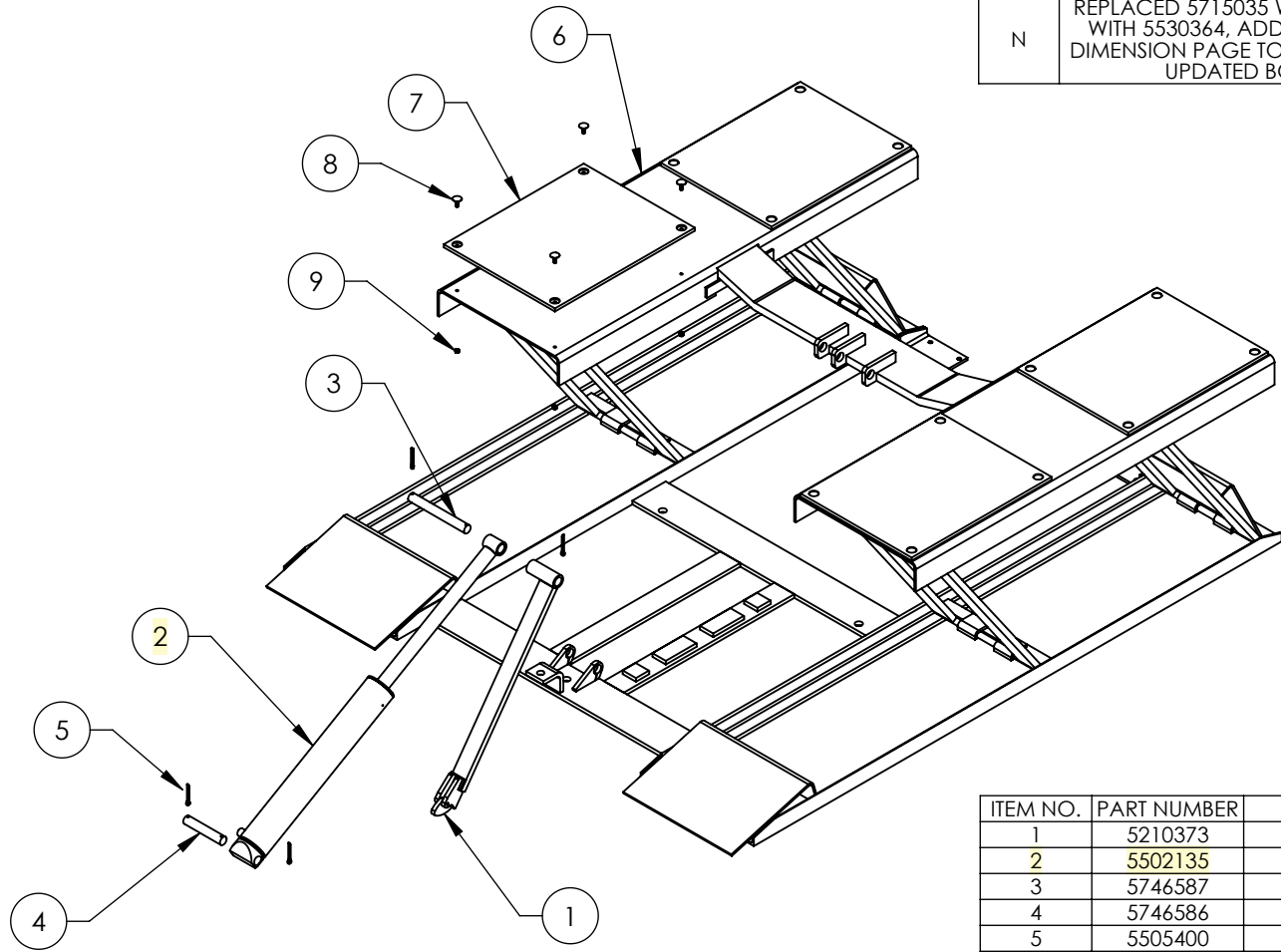

ITEM NO.	PART NUMBER	DESCRIPTION	QTY.	REV
1	5210373	LR-60/60P SAFETY BAR ASSEMBLY	1	D
2	5502135	CYLINDER ASSEMBLY Ø3.0 X 18	1	E
3	5746587	UPPER HINGE PIN	1	B
4	5746586	DLR-6/LR-60 LOWER CYLINDER PIN	1	B
5	5505400	COTTER PIN Ø6 x 50mm	4	-
6	5600526	LR-60 LIFT WELDMENT	1	K
7	5715048	DLR-6, LR-60 RAMP BOLT-ON RUBBER PAD	4	A
8	5530364	ELEVATOR BOLT M6 x 1.0 x 25	16	A
9	5535357	NUT M6 x 1.0 NL	16	B

WHERE USED
LR-60 SERIES

NOTE: UNLESS OTHERWISE SPECIFIED.

1. REFER TO MODEL FOR ADDITIONAL INFORMATION
2. SEE COLORS & GRAPHICS FOR LABEL PLACEMENT
3. SEE SHIPPING INSTRUCTIONS FOR FINAL PACKAGING
4. ASSEMBLE ITEMS AS SHOWN

NEXT ASSEMBLY
5260167
5260168

DO NOT SCALE DRAWING

DIMENSIONS ARE IN MM



NAME	DATE
DRAWN TM	10/04/2010
CHECKED OR	08/26/2022

THIRD ANGLE PROJECTION



PROPRIETARY AND CONFIDENTIAL
THE INFORMATION CONTAINED IN THIS DRAWING IS
THE SOLE PROPERTY OF BENDPAK INC. ANY
REPRODUCTION IN PART OR AS A WHOLE WITHOUT
THE WRITTEN PERMISSION OF BENDPAK INC. IS
PROHIBITED.



1645 LEMONWOOD DR.
SANTA PAULA, CA 93060

TITLE: LR-60/60P LIFT
SUPERSTRUCTURE

SIZE	DWG. NO.	REV
A	5245233	N

SCALE: 1:20

SHEET 1 OF 1