

BASELINE™

Swing Arm Kit 85610499 Rework Instructions

Hennessy Industries, Inc. • 1601 J.P. Hennessy Drive, LaVergne, TN 37086
(800) 688-6359 • (615) 641-7533 • (615) 641-5104 FAX • www.baseline garage.com

BaseLine 500 Rework Instructions

Parts List: Sleeve (85610471) and Spacer (85610472)

1. Remove Swing Arm Assembly.
2. Remove Swing Arm Sleeve (85607633).
3. Place existing Washer (8182457) on 14" Bolt.
Slide new Arm Sleeve (85610471) onto the Bolt with the Chamfer side down toward the bottom.
4. Slide assembly through the Tower and Swing Arm Assembly with Washer (85606987) installed.
5. Place new Spacer (85610472) on the Bolt with the Chamfer side down toward Swing Arm.
6. Reassemble the remaining Swing Arm Assembly components.
Tighten Bolt and Nut to **240 FT-LBS**.
7. Verify side to side movement is smooth and **Not** too tight.
8. Verify that there is **Not** any movement in the arm when pulling the Duck Head up.

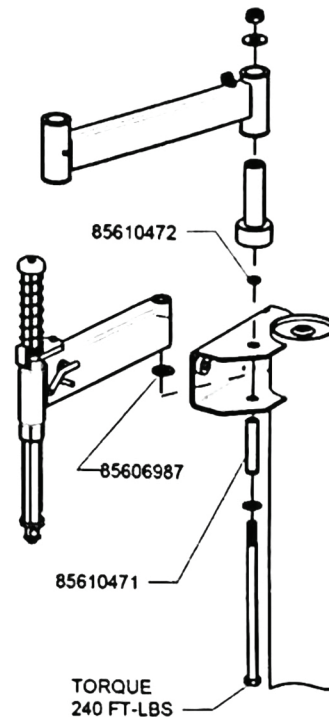

BaseLine 300 Rework Instructions

Parts List: Sleeve (85610471), Spacer (85610472), Bolt (85610016) and Washer (8182457)

1. Remove Swing Arm Assembly.
Remove existing Bolt (85606986) and discard.
Remove existing Swing Arm Sleeve (85607633) and discard.
2. Place new Washer (8182457) on new Bolt (85610016).
Slide new Arm Sleeve (85610471) onto the Bolt with the Chamfer side down toward the bottom.
3. Slide assembly through the Tower and Swing Arm Assembly with Washer (85606987) installed.
4. Place new Spacer (85610472) on the Bolt with the Chamfer side down toward Swing Arm.
5. Reinstall the remaining Swing Arm Assembly components.
Tighten Bolt and Nut to **240 FT-LBS**.
6. Verify side to side movement is smooth and **Not** too tight.
7. Verify that there is **Not** any movement in the arm when pulling the Duck Head up.

